

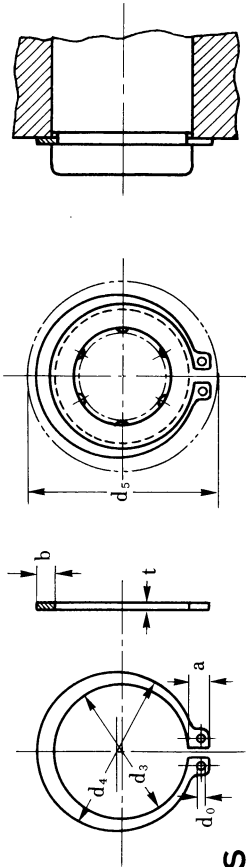

Stop Rings for Out Side of Linear Bearings



d_5 is minimum inside diameter

Linear Bearings Model No.	Nominal Dia.	J I S		Ogura	Iwata	d_3		t		d_0	d_5
		C Type	S Type			Inside Dia.	Tolerance	Thickness	Tolerance		
L5A,L5B	10	◎	◎	◎	◎	9.3	±0.15	1	1.6	3	1.2
L6,LE5,LE6	12	◎	◎	◎	◎	11.1	±0.18	1	1.8	3.2	1.5
L8A,L8B	15	◎	◎	◎	◎	13.8			2.1	3.5	1.7
LE8	16	◎	◎	◎	◎	14.7	2.2	3.6	24		
L10,LE10	19	◎	◎	◎	◎	17.5	2.7	3.8	27		
L12	21	◎	◎	◎	◎	19.5	2.7	4	30		
LE12	22	◎	◎	◎	◎	20.5	2.7	4.1	31		
L13	23	—	◎	◎	—	21.5	±0.05	1.2	2.7	4.1	32
LE16	26	◎	◎	◎	◎	24.2	±0.2	3.1	3.1	4.4	35
L16	28	◎	◎	◎	◎	25.9	±0.06	1.6	3.1	4.6	38
L20,LE20	32	◎	◎	◎	◎	29.6	±0.06	1.6	3.5	5	43
L25A,L25B,LE25	40	◎	◎	◎	◎	37	±0.06	1.8	4.5	5.8	53
L30A	45	◎	◎	◎	◎	41.5	±0.4	1.8	4.8	6.3	58
L30B,LE30	48	◎	◎	◎	◎	44.5			4.8	6.5	61
L35	52	◎	◎	◎	◎	47.8	±0.07	2	5	6.8	66
L40	60	◎	◎	◎	◎	55.8	±0.45	2	5.5	7.2	75
LE40	62	◎	◎	◎	◎	57.8			5.5	7.2	77
L50A,LE50	75	◎	◎	◎	◎	70.5	±0.08	2.5	7	7.9	93
L50B	80	◎	◎	◎	◎	74.5	±0.08	2.5	7.4	8.2	97
L60,LE60	90	◎	◎	◎	◎	84.5	±0.55	3	8	8.7	108
L80,LE80	120	◎	◎	◎	◎	113			±0.09	4	10.3
L100	150	—	◎	◎	G Type	142	±0.65	4	10.5	12.3	175

Stop Rings for Housing Bore

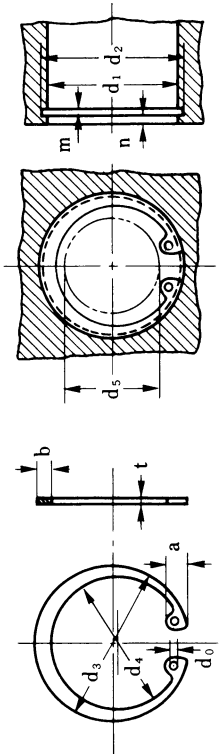

d_5 is minimum inside diameter

Linear Bearings Model No.	Nominal Dia	JIS		Ogura		Iwata		d_3		t		a	d_0	d_5	d_1		d_2		m		n
		C Type	H Type	H Type	O Type	Inside Dia.	Tolerance	Thickness	Tolerance	Tolerance	Tolerance				Tolerance	Tolerance	Tolerance	Tolerance			
L3	7	—	○	○	○	7.5	+0.12	0.4	±0.03	—	—	—	0.8	4.3	7	7.4	±0.05	0.45	+0.05	1.0	
L4	8	—	—	—	○	8.7	-0.05	—	—	—	—	—	—	5.3	8	8.5	±0.05	—	—	—	
L5A,L5B	10	—	—	—	○	10.8	+0.25	0.65	±0.03	—	—	—	1.0	6.6	10	10.6	±0.07	0.73	—	—	
L6,LE5,LE6	12	—	—	—	○	12.7	-0.12	—	—	—	—	—	1.2	7.6	12	12.5	±0.07	—	—	—	
L8A,L8B	15	○	○	○	○	16.2	±0.18	—	—	—	—	—	1.7	8	15	15.7	+0.11	—	—	—	
LE8	16	○	○	○	○	17.3	—	—	—	—	—	—	—	8	16	16.8	0	—	—	—	
L10,LE10	19	○	○	○	○	20.5	—	1	±0.05	2	3.6	—	—	11	19	20	—	1.15	—	—	
L12	21	○	○	○	○	22.5	—	—	—	—	—	—	—	12	21	22	—	—	—	—	
LE12	22	○	○	○	○	23.5	±0.2	—	—	—	—	—	—	13	22	23	+0.21	—	—	—	
L13	23	—	—	—	○	24.6	—	—	—	—	—	—	2	14	23	24	0	—	—	—	
LE16	26	○	○	○	○	27.9	—	—	—	—	—	—	—	16	26	27.2	—	—	—	—	
L16	28	○	○	○	○	30.1	±0.25	—	±0.06	3	4.6	—	—	18	28	29.4	—	—	—	—	
L20,LE20	32	○	○	○	○	34.4	—	—	—	—	—	—	—	21	32	33.7	—	—	—	—	
L25A,L25B,LE25	40	○	○	○	○	43.5	±0.4	—	—	—	—	—	—	28	40	42.5	+0.25	—	—	—	
L30A	45	○	○	○	○	48.5	—	—	—	—	—	—	—	33	45	47.5	0	—	—	—	
L30B,LE30	47	○	○	○	○	50.5	—	—	±0.07	4	5.7	—	—	34	47	49.5	—	—	—	—	
L35	52	○	○	○	○	56.2	—	—	—	—	—	—	—	39	52	55	—	—	—	—	
L40	60	○	○	○	○	64.2	±0.45	—	—	—	—	—	—	46	60	63	+0.3	—	—	—	
LE40	62	○	○	○	○	66.2	—	—	—	—	—	—	—	48	62	65	0	—	—	—	
LE50	75	○	○	○	○	79.5	—	—	±0.08	5	6.8	—	—	60	75	78	—	—	—	—	
L50A	78	○	○	○	G Type	82.5	±0.55	—	—	—	—	—	—	64	80	83.5	+0.35	—	—	—	
L50B	80	○	○	○	○	85.5	—	—	—	—	—	—	—	73	90	93.5	0	—	—	—	
L60,LE60	90	○	○	○	○	95.5	—	—	±0.09	7	8	—	—	98	120	124	+0.63	—	—	—	
L80,LE80	120	○	○	○	○	127	±0.65	—	±0.08	10	11.5	—	—	126	150	155	0	—	—	—	
L100	150	—	—	—	—	158	—	—	—	—	—	—	—	—	—	—	—	—	—	—	